

ZB0281

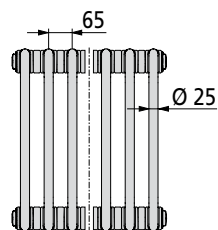

ZB0305

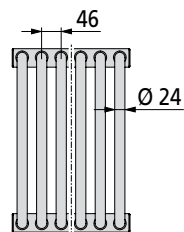

AKP® 2014/02 • 6910092

- DE – Montageanleitung Klemmhalter (Anwendung siehe Unterlagen des Herstellers)  
 EN – Installation instructions – Clamp (For usage, see manufacturer's documents)  
 FR – Instructions de montage de la pièce de fixation (pour l'utilisation, consulter la documentation du fabricant)  
 IT – Istruzioni di montaggio staffa di bloccaggio (Applicazione vedere documentazione del produttore)  
 RU – Руководство по монтажу зажима (использование см. в документации производителя)  
 CS – Návod k montáži svorkového držáku (použití viz dokumentaci výrobce)  
 NL – Montagehandleiding klembeugel (toepassing zie documentatie van de leverancier)  
 ES – Instrucciones de montaje del soporte de apriete (véase la documentación del fabricante para su aplicación)  
 ZH – 夹紧支架安装说明 (用途参见制造商的资料)  
 PL – Instrukcja montażu zacisków (zastosowanie patrz dokumentacja producenta)  
 EL – Οδηγίες τοποθέτησης σταθεροποιητή σύσφιξης (για εφαρμογή βλέπε τεχνικά έγγραφα του κατασκευαστή)  
 FA – دفترچه راهنمای نصب صاحب گیره (کاربرد، به مستندات تولیدکننده مراجعه نمایید)

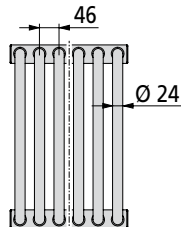
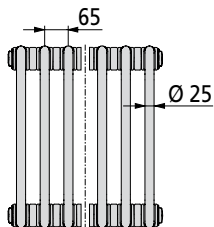
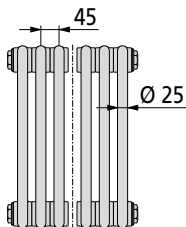
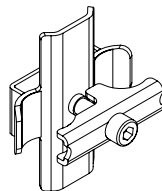
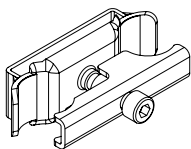
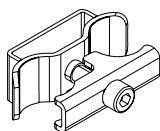
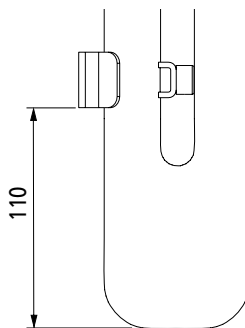
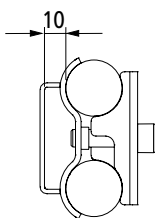
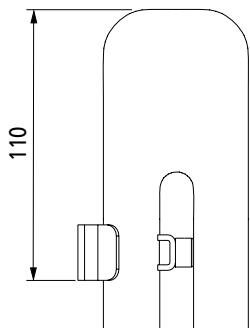
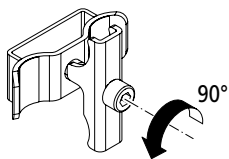
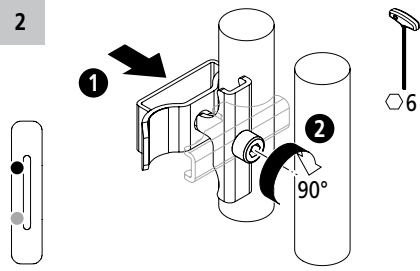
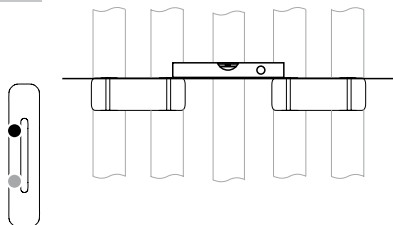
**A****B****1****2****3****4**